

The image features a modern, multi-story apartment building with a mix of beige and white facades, large windows, and balconies. The building is set against a clear blue sky. In the foreground, there are several tall palm trees and some flowering bushes. A paved walkway with a few people is visible at the bottom. The entire scene is framed by a large, white, curved graphic element on the left side that has a subtle grid pattern. In the top right corner, there is a dark blue semi-circular overlay containing the project's logo and name.

AXIS
RESIDENCE
Nyali - Mombasa

**WHERE LIFE
ENCOUNTERS
SERENITY**



AXIS
RESIDENCE

ABOUT THE RESIDENCE

A new kind of lifestyle awaits. Here spacious floor plans take priority over the number of apartments. It means that few get a lot more. The Axis Residence is a unique development along Mbuni road with only 40 apartments on offer

All the apartments are 3,336 Square feet in size, three bedroomed all ensuites with a Servant quarters, common pool, Gym, dedicated parking space, standby Generator, High Speed Lifts, Access control and the apartments enjoy the luxury of space.

The location is absolutely stunning. The Residence is located in the quiet neighborhood within close proximity to:

- * Golf course
- * The beach
- * Cinemax
- * Premier Hospital
- * Light Academy
- * Nyali primary
- * 15 mins to the CBD

This sets a new benchmark in apartment living.



MAKE IT YOUR *Home*



SPECIFICATIONS

ALL BEDROOMS

Flooring / Skirting:	Porcelain tiles minimum size 600x1200 mm
Wall Finishes:	Silk vinyl Paint
Ceiling:	Silk vinyl Paint, gypsum Upon request

LOUNGE/DINING ROOM

Flooring / Skirting:	Porcelain tiles minimum size 600x1200 mm
Wall Finishes:	Silk vinyl Paint
Ceiling:	Silk vinyl Paint, gypsum Upon request

TOILETS/CLOAK

Flooring / Skirting:	Non Slip Porcelain tiles minimum size 600x1200 mm
Wall Finishes:	Porcelain tiles up to dado level (Approximately 2400mm)
Upper Wall Finishes:	Silk vinyl Paint above dado level
Counter:	Granite
Sanitary ware:	Premium Quality Range Kohler or matching equivalent

STAIRCASE

Flooring / Skirting:	Porcelain tiles minimum size 600x1200 mm
Wall Finishes:	Silk vinyl Paint
Railings:	Marine primed and painted M.S. Railings

KITCHEN

Flooring / Skirting:	Non Slip Porcelain tiles minimum size 600x1200 mm
Wall Finishes:	Porcelain tiles up to 600mm above counter and silk vinyl paint in the balance areas
Ceiling:	Silk vinyl Paint, gypsum Upon request

TOILET FITTINGS AND ACCESSORIES

Taps/Mixers:	Kohler or equivalent
Details:	Single lever fittings in all toilets, Provision for geyser, Handset shower, Rain shower in master bathroom

LIFT LOBBY

Flooring:	Granite/Marble/Porcelain tiles minimum size 600x1200 mm
Wall Finishes:	Granite/Marble up to 2100mm on the lift side wall and silk vinyl paint in the balance of the areas

COMMON PASSAGE

Flooring:	Granite/Marble/Porcelain tiles minimum size 600x1200 mm
Wall Finishes:	Granite/Marble up to 2100mm on the lift side wall and silk vinyl paint in the balance of the areas
Ceiling:	Silk Vinyl Paint

DOORS

Main Entrance Door:	Varnished mulli hardwood frame with 2 inch hardwood panel
Internal Doors:	Varnished mulli hardwood frame with 1 inch hardwood panel
Hardware:	Locks, handles and knobs (Mortise and Cylindrical locks) from reputed makes and brands. High quality steel/brass hardware

WINDOWS AND EXTERNAL GLAZING

Frames:	Powder coated aluminum frame with clear glass
---------	---

EXTERNAL WALL FINISH

Finish:	Exterior grade paint from reputed makes and brands
---------	--

INTERIOR

The apartments blend into the Nyali landscape seamlessly, offering a tranquil life surrounded by all the amenities a household will ever need.

Built in modern style and with the best choice of materials—coral stone, quality porcelain tiles and mvule hardwood—the units will be imbued with an indefinable feeling of calm and serenity - a serenity which will overflow into the daily lives of the owners.



KITCHEN

To return home from work or a day out and find oneself in a place of such natural beauty will surely calm and revitalise all the senses.

INTERIOR LAYOUT



LOUNGE



*A magical and continuing encounter
between life and serenity.*



OPTIONAL KITCHEN ACCESSORIES



KITCHEN

DINNING AREA



M/BEDROOM



BEDROOM

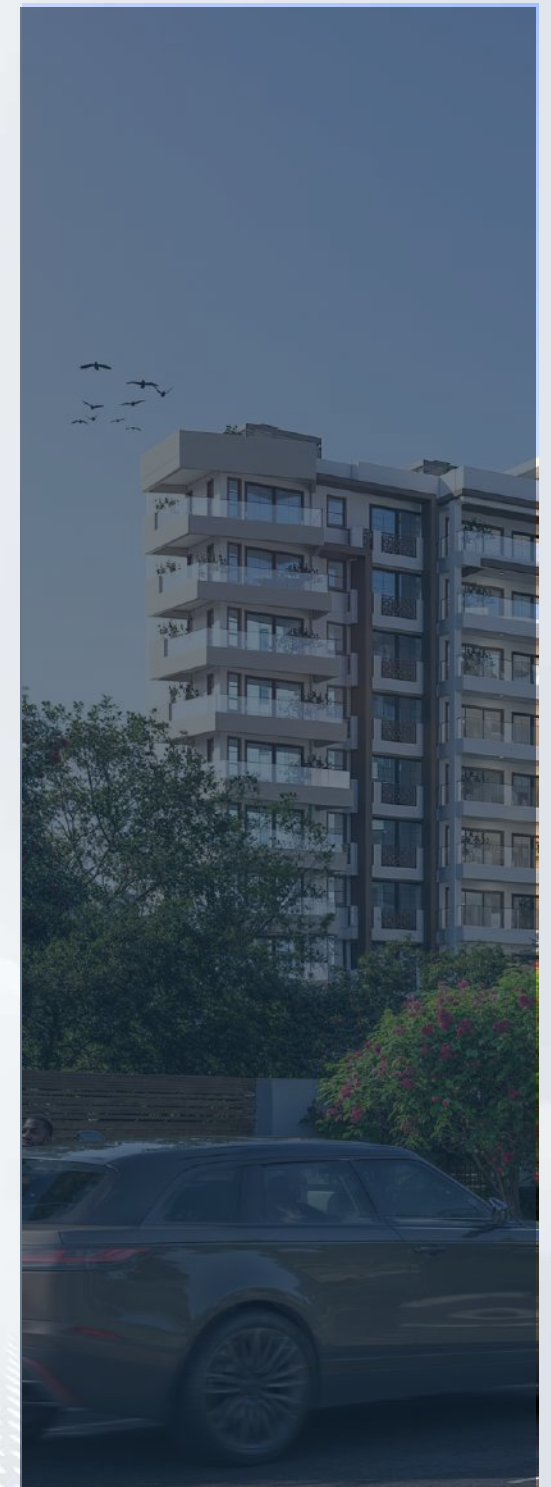

A photograph of a modern walk-in closet. The room features light-colored wood-look herringbone flooring, white cabinetry with open shelving, and a window with blinds at the far end. A large window with blinds is visible on the left side of the frame. The ceiling has recessed lighting.

WALK IN CLOSET



BATHROOM



INDOOR GYM

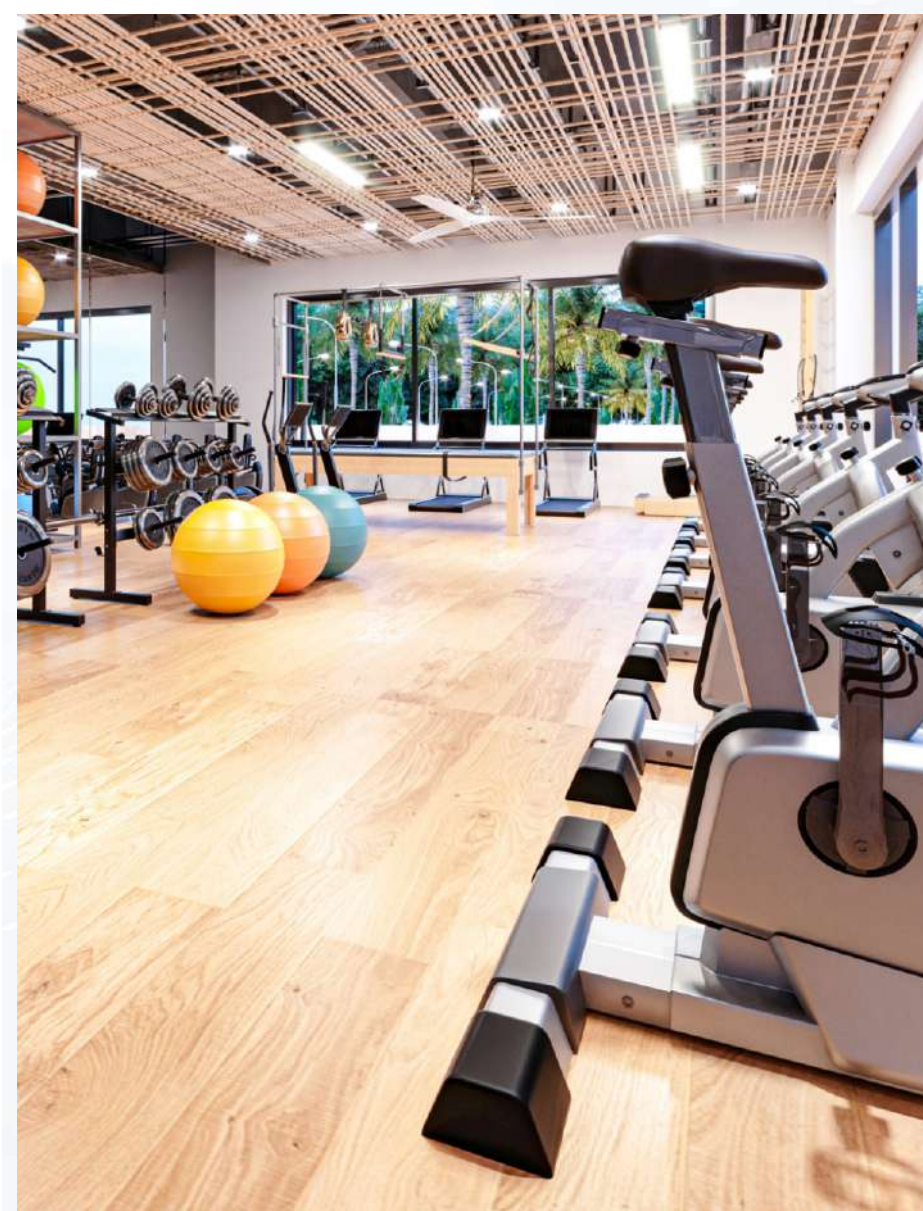

A photograph of a modern swimming pool. The pool is filled with clear, turquoise water and is surrounded by a concrete deck. In the background, there is a multi-story building with a dark facade and several windows with decorative, white, geometric lattice patterns. To the left of the pool, there is a lush green wall of climbing plants. In the foreground, the words "Swimming Pool" are written in a white, cursive font. The overall scene is bright and sunny, suggesting a pleasant outdoor environment.

Swimming Pool

INTERIOR PLAN

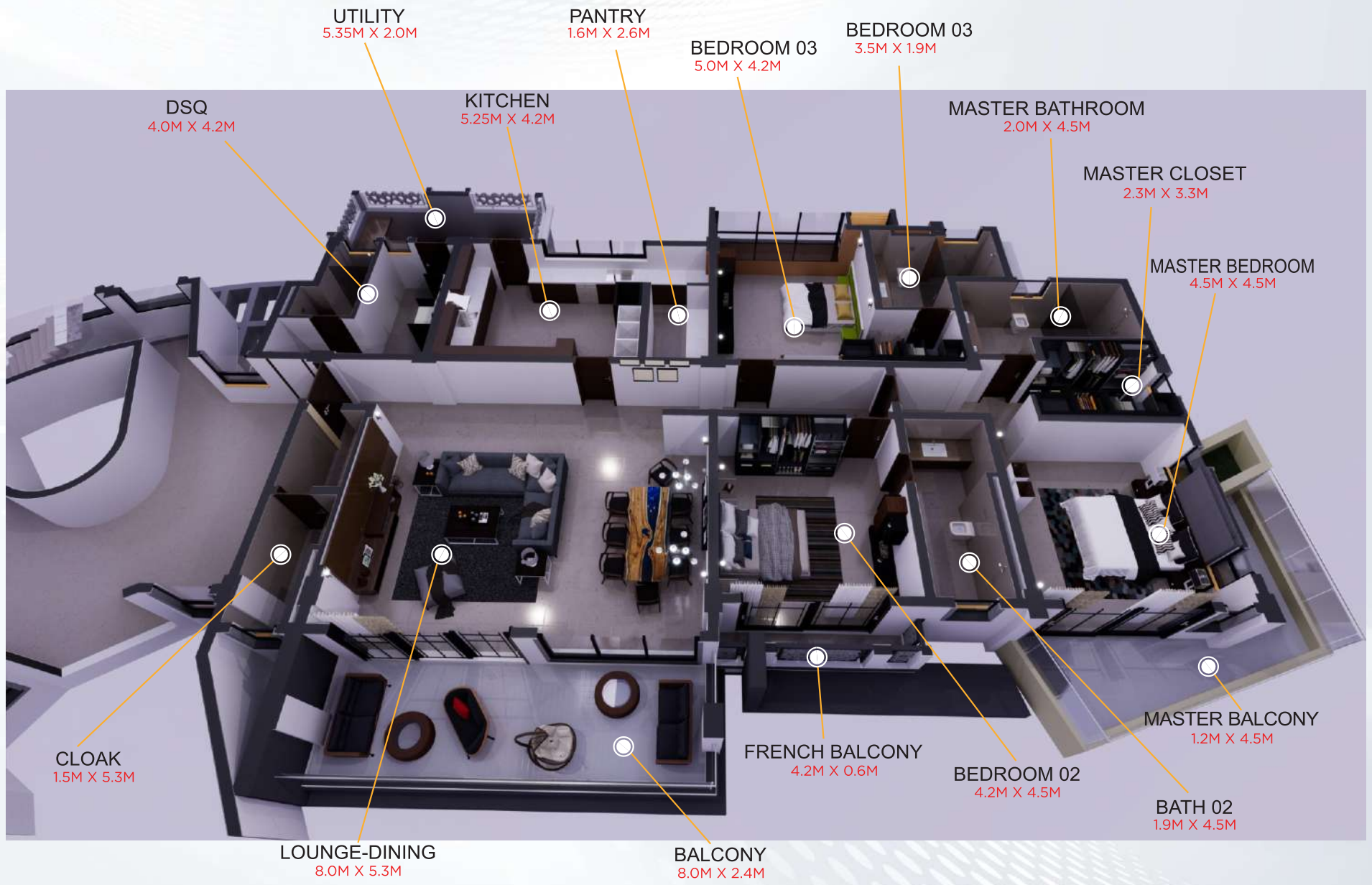



DISCLAIMER: Computer generated images, walk-throughs and render images used in this brochure are the artists impression and are an indicative of the actual designs. The imagery used on the brochure may not represent the actual finished units. The construction may vary in fit and finish from the one displayed in the information and material displayed on this document. The document's particulars are compiled with great care to give a fair description of the project but they do not constitute an offer or contract.

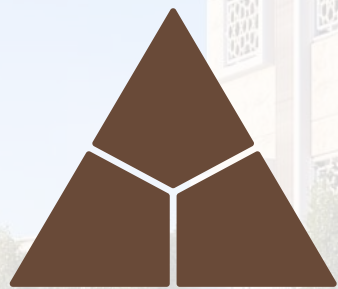

AXIS

RESIDENCE

